

# FOLDING BACKREST INSTALLATION GUIDE

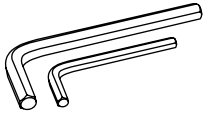

## GATHER WHAT YOU NEED:

- 4mm Allen Key
- 6mm Allen Key

**NB:** For clarity, the illustrations do not show the backrest fabric installed. Please keep the fabric installed at all times during assembly.

1

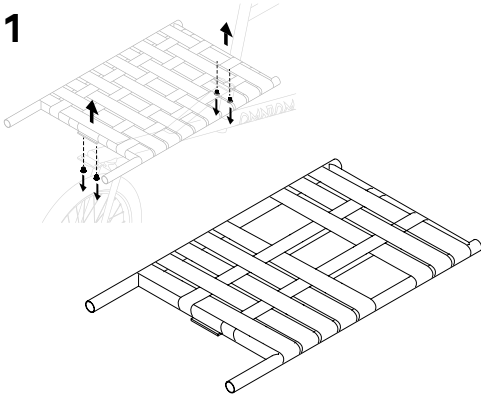

## RACK PREP:

- Remove rack from frame  
*not necessary if using webbing V2 / Dual-Axis*
- Remove the two transverse and longitudinal webbing straps. See the illustration for the final webbing position.
- If the rack was removed from the frame, reinstall it before mounting the backrest. This will make the backrest installation easier

2

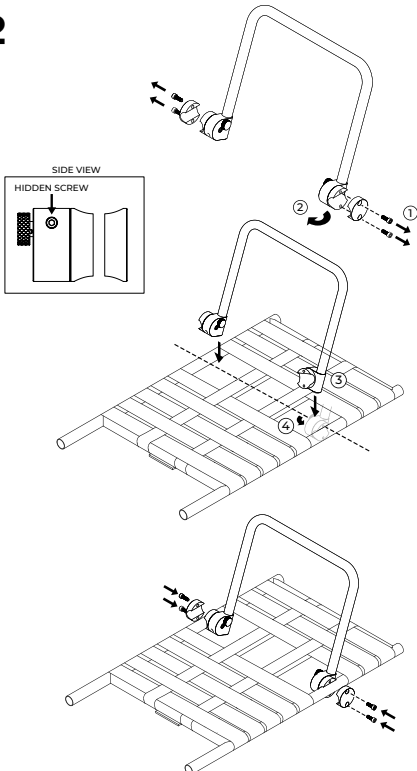

## BACKREST PREP:

- Start by removing the **four M8 bolts** from both sides of the backrest assembly.
- Remove the outer clamp plates.
- On one side only, loosen the hidden screw and rotate the backrest side piece 90°.
- Attach the side that has not been rotated to the rack and tighten the bolt to **5 Nm**.
- Turn the other side back to 0 degree position, and fasten that side to the rack.

# FOLDING BACKREST INSTALLATION GUIDE

3

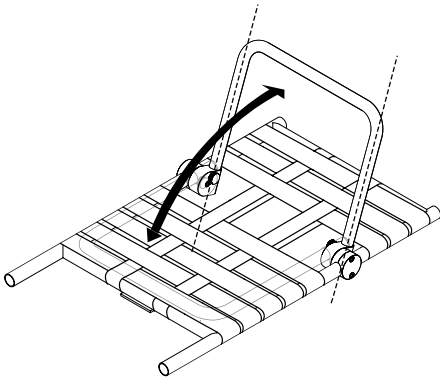

## VERIFY:

- Make sure that the two sides on the backrest is positioned parallel to each other, and that the backrest tube sits in the same position in both side of the clamps.
- Tilt the backrest back and forth a couple of time, and make sure it moves smoothly.
- Fasten both loose hidden bolt to **4 Nm, or until snug.**
- Check that the movement and locking spring plunger function interact correctly.

4

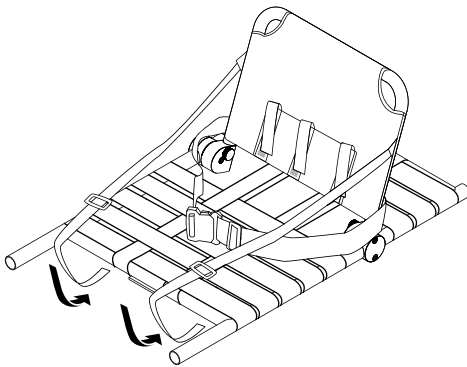

## ATTACHING THE SIDE STRAPS:

- Make sure the side straps and webbing sliders are positioned as shown in the illustration.
- Route the loose strap end around the front transverse tube of the rack.
- Feed the loose end back through the webbing slider.
- Loop the loose end underneath and back through the webbing slider to secure it.
- Adjust the side straps until they are evenly tensioned.

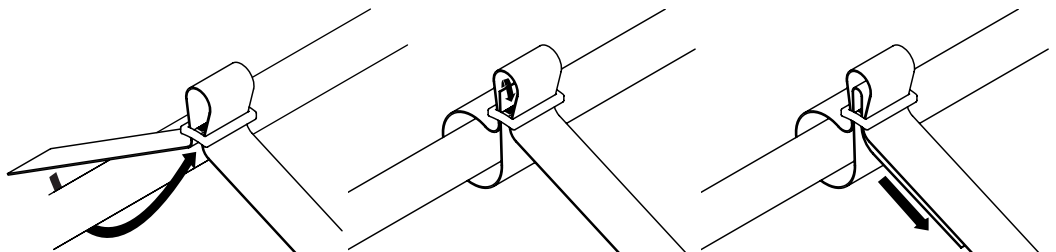

# FOLDING BACKREST INSTALLATION GUIDE & USE



5

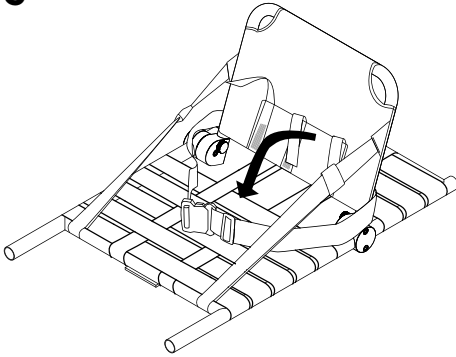

## PUTTING THE BOTTOM COVER:

- Open all three Velcro loops.
- Wrap each loop around the nearest transverse webbing strap.
- Secure the Velcro loops tightly around the webbing straps.

## USES:

The backrest has two positions only:

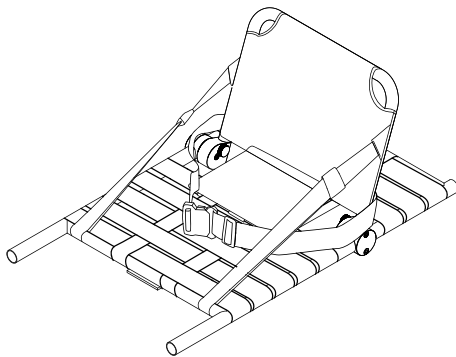

Open position — 110°

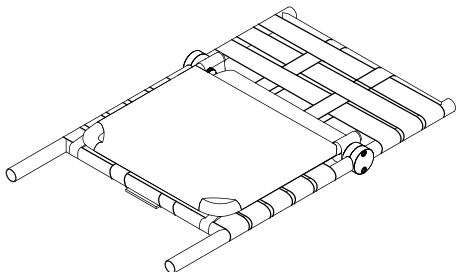

Folded position — 0°

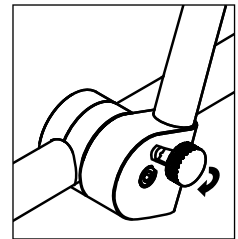
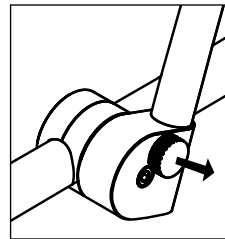

- To change position, retract the spring plungers and rotate them 90° on both sides.
- Move the backrest to either the folded or open position.
- Rotate the plungers back so they fully engage and lock the pivot points in place.
- Always make sure both pivot points are securely locked before using the backrest.
- Make sure the seat belt is always used and adjusted correctly to fit the passenger's size.
- Make sure the side straps are correctly tensioned before use.
- Never use the backrest if the pivot points are not locked correctly.

# FOLDABLE BACKREST MAINTENANCE GUIDE



All moving parts and adjacent surfaces need to be maintained and cleaned occasionally.

## CLEANING AND GREASING THE LOCKING FEATURES

If the backrest does not move or lock correctly, maintenance may be required.

1. Start by removing the two hidden bolts (M5) and slide the backrest tube out of the clamps.
2. Loosen the M8 bolt on the inside of each backrest clamp until the inner clamp piece can be removed.
3. Clean both the inner and outer clamp parts thoroughly, making sure all dirt and debris are removed.
4. Apply an appropriate weather-resistant grease to all contact and moving surfaces.
5. Reinstall the inner clamp parts and tighten the M8 bolts to 5 Nm.
6. Reinstall the backrest tube into the clamps and tighten the hidden bolts to 4 Nm, or until snug.

## LOCKING SPRING PLUNGER

If the spring plunger does not move freely, it may require cleaning and lubrication.

### IMPORTANT

Never attempt to screw the plunger in or out. The plunger is bonded to the aluminium clamp and is not removable.

1. If the plunger is stuck, use pliers or a flat-blade screwdriver to carefully move the knurled head back and forth.
2. Work the plunger slowly until it moves freely again.
3. Apply an appropriate weather-resistant grease to the moving shaft of the plunger.

# FOLDABLE BACKREST

## SAFETY AND DISCLAIMER



PLEASE READ ALL OF THE FOLLOWING SAFETY INSTRUCTIONS AND USAGE GUIDELINES CAREFULLY AND KEEP THEM FOR FUTURE REFERENCE

FAILURE TO COMPLY WITH THESE INSTRUCTIONS PROVIDED COULD LEAD TO SERIOUS INJURY OR DEATH OF THE BICYCLE OPERATOR AND/OR CHILD

### SAFETY INFORMATION

- a. **Never attempt to unscrew the spring plungers.** They are permanently bonded into position.
- b. **Always make sure the backrest is correctly installed and all bolts are tightened to the specified torque before riding.**
- c. **Inspect the backrest regularly** for loose bolts, wear, damage, or improper function.
- d. **Ensure the locking spring plungers are fully engaged before carrying passengers or cargo against the backrest.**
- e. **Keep fingers, hands, clothing, and straps away from moving parts and pivot areas** during adjustment and folding. Pinch hazards may occur during operation.
- f. **Do not use the backrest if any part appears damaged, bent, cracked, or does not function correctly.**
- g. **The Folding Backrest is intended for use only with compatible Omnum racks** and for its intended purpose.
- h. **The seat is designed for children approximately 5–8 years of age.** Always ensure the passenger fits securely and comfortably in the seating area, and **never exceed the maximum permitted load capacity of the rack.**
- i. **Always secure cargo properly and ensure passengers are seated safely** and supervised when applicable.
- j. **Passengers should always wear properly fitted helmets and remain correctly seated with the seat belt securely fastened while the bicycle is in use.**
- k. **Riding characteristics may change when carrying passengers or heavy cargo.** Ride carefully and adjust speed accordingly.
- l. **Regular cleaning and maintenance of moving parts and locking mechanisms are required** to ensure safe operation.

### ▲ DISCLAIMER ▲

The Omnum Folding Backrest is intended for use only as described in this manual. Improper installation, modification, misuse, lack of maintenance, or use outside intended conditions may result in product failure, serious injury, or death.

The user is responsible for ensuring correct installation, inspection, maintenance, and safe use of the product at all times.

Omnum is not responsible for damage, injury, or loss resulting from:

- **Improper installation or assembly**
- **Failure to follow instructions or maintenance guidelines**
- **Unauthorized modifications**
- **Misuse, overloading, or accidents**
- **Normal wear and tear**

Always follow local laws and regulations regarding passenger and cargo transport by bicycle.